

Bezalel Academy of Art and Design

The name of Bezalel is synonymous with 100 years of Israeli art, innovation and quality. Established in 1906, it is home to 1,765 students, 400 teachers and another 100 employees supporting the study of architecture, ceramic and glass design, fine arts, industrial design, jewelry and fashion, photography and visual communications. Spread over three campuses, the Academy is moving their campus from the outskirts of Mount Scopus to an intriguing, historical site in the heart of Jerusalem.

Bezalel opened an international competition in 2007 for a facility design to accommodate not only the multiple creative departments but also to negotiate challenges presented by both the historical district and the shape and condition of the available site.

The design of this project is based on Robert Frost's legendary poem "mending walls", in which he suggests: that which divides can also unite.

This project promotes community, sponsors discourse, and enables creativity between students, faculty and most importantly passersby. The creation, conversation, and display of art is made spatial and IS the architecture.

Connecting the stone and glass paths is an innovative network of floors and mezzanines. The floors integrate different disciplines and layer closed classroom spaces, studio workspaces and the conversation panel spaces. A walk through the floors suggests cross pollination of disciplines and ideas.

The mezzanines offer non-programmed space and a unique overhead vantage. Connecting the stone and glass stairs at the mid-level landings, the mezzanines are at once quick cross floor shortcuts, studio and panel space overlooks, and late night lounge space - a relief from studio. By offering another path, another perspective, the floors and mezzanines are a metaphor for understanding. Their behavior connects people.

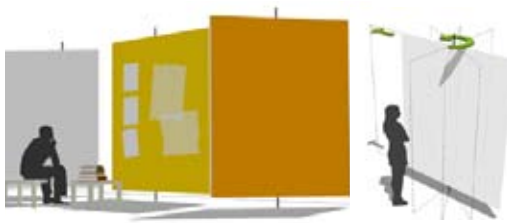
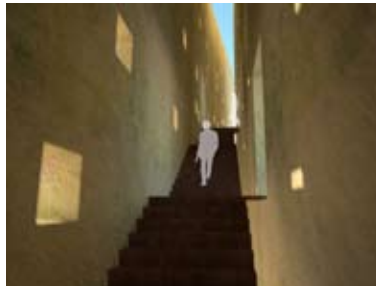

Bezalel Academy of Art and Design

(cont.)

Sustainable Design Elements:

The mending walls have a multitude of functions: uniting the site and the academy while creating a plaza, spatial program dividers, vertical circulation passages, daylight control, and airflow control.

The building is breathing. Vents open and close as necessary to naturally ventilate the interior. Drawing air into the geothermal heat exchanger below where natural convection lifts the air up through the studios. Air is pulled through the Great Void over the cooling pools and into the studios. Warm air is contained or expelled to the exterior. A homeostatic state is achieved as the seasons change.

The concrete structure and the stone Mending Walls provide thermal mass which mitigates temperature swings in the building.

The building captures and controls daylight for the occupants within. The artist panels rotate to control light to the artist needs. Small, deep-punched openings on the exterior and the interior of the East and West Stone mending walls control glare and provide borrowed light to the adjacent studios and office spaces. The interior glazed Mending Walls act as light wells, bringing bounced, glare-free light deep into the building's interior.

The building generates and saves energy.

The photovoltaic "solar roof" generates power from the golden sun. While photovoltaic cells in the south glazing shade the studios and provide yet more power. Combined with the geothermal heat exchange system, these methods offset more than 50% of the total power load.

